

sd200v Notebook docking station with video

- QUICK START GUIDE
- GUIDE DE DEMARRAGE RAPIDE
- KURZANLEITUNG
- SNELSTARTGIDS
- GUIDA VELOCE
- MANUAL DE INICIO RÁPIDO

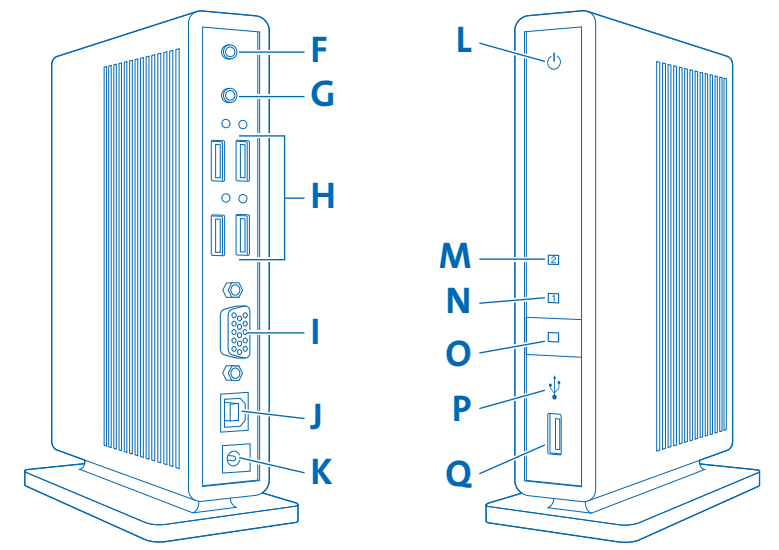
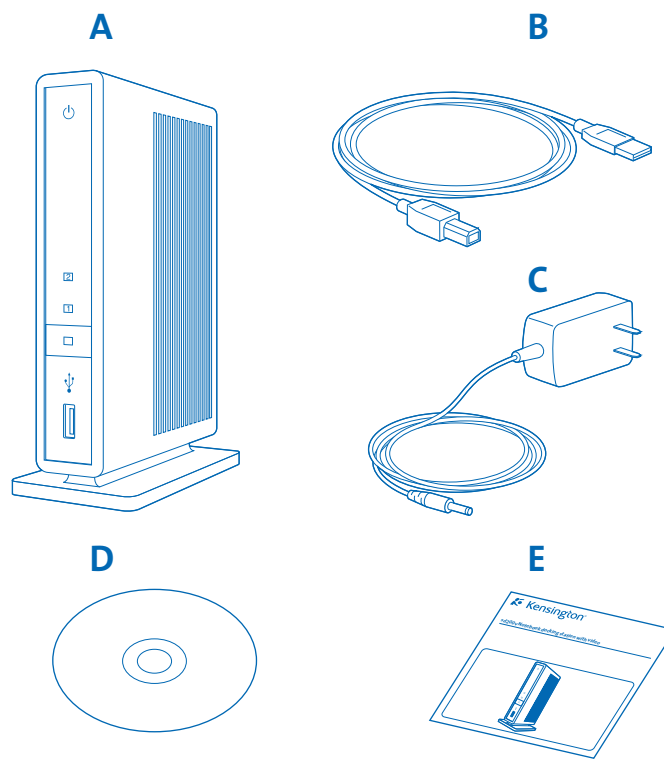
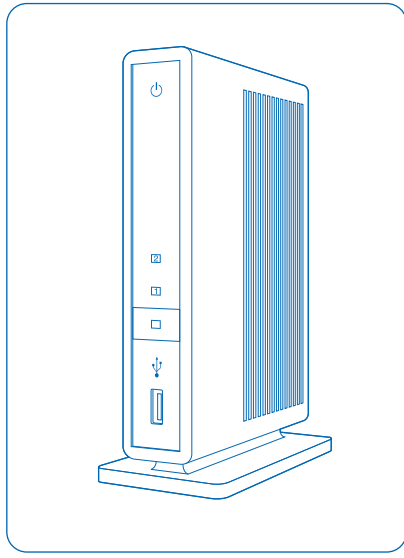

English

Contents

- A. sd200v Notebook docking station with video
- B. USB 2.0 cable
- C. Power adapter
- D. Software Installation CD and Instruction Guide
- E. Quick Start Guide

Components

Back

- F. Stereo audio output
- G. Microphone input
- H. 4 USB 2.0 ports with status indicator lights
- I. VGA video output
- J. USB upstream connector
- K. Power adapter jack

Front

- L. Power/connection indicator light
- M. Display mode indicator light 2
- N. Display mode indicator light 1
- O. DualView button
- P. Front USB connection status light
- Q. USB 2.0 port

Set Up and Connect Docking Station

- 1 Insert CD into notebook.

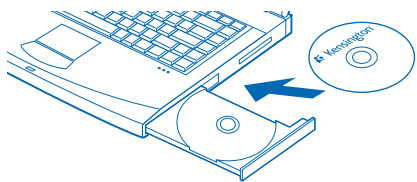

- 2 Follow onscreen instructions.  
**Note:** During the installation, notebook screen may go blank for a few seconds. This is a normal part of the installation process.
- 3 Reboot notebook if prompted.
- 4 Attach power adapter to docking station and to working wall outlet.

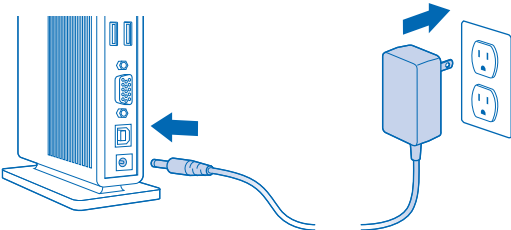

- 5 Attach USB 2.0 cable to USB upstream connector on docking station.

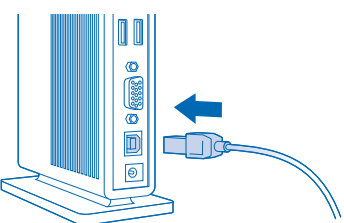

- 6 Attach USB 2.0 Cable to USB port on notebook.

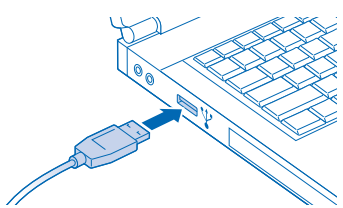

- 7 Connect devices—mice, monitor, and so on—to docking station.

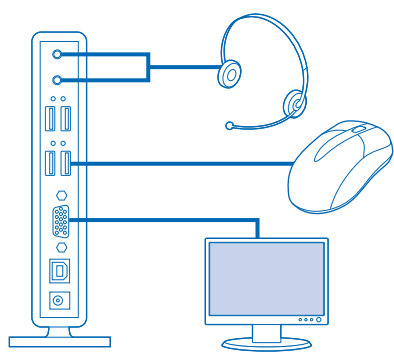

- 8 (Optional) If monitor is connected, adjust display settings:
  - a Right-click Kensington icon in taskbar.
  - b Select Extended (DualView) or Clone.
  - c Select desired screen resolution.

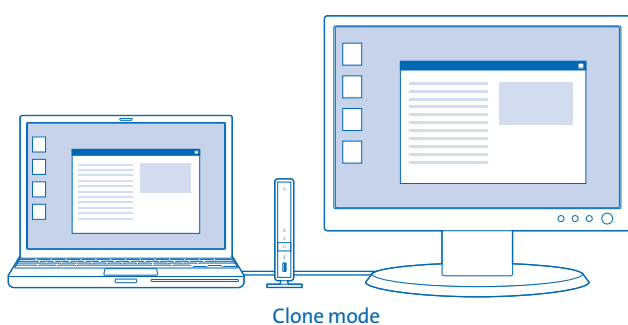
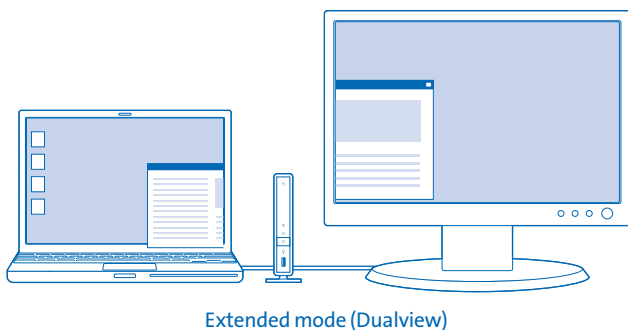

- 9 (Optional) To view detailed Instruction Guide, go to Start/All Programs/sd200v.

Français

Contenu

- A. Station d'accueil avec vidéo sd200v pour ordinateur portable
- B. Câble USB 2.0
- C. Alimentation
- D. CD d'installation du logiciel et Guide d'instructions
- E. Guide de démarrage rapide

Composants

Arrière

- F. Sortie audio stéréo
- G. Entrée microphone
- H. 4 ports USB 2.0 avec voyants lumineux d'état
- I. Sortie vidéo VGA
- J. Connecteur USB
- K. Prise pour alimentation

Avant

- L. Voyant lumineux d'alimentation/connexion
- M. Voyant lumineux du mode d'affichage 2
- N. Voyant lumineux du mode d'affichage 1
- O. Bouton DualView
- P. Voyant d'état de la connexion USB avant
- Q. Port USB 2.0

Installation et connexion de la station d'accueil

- 1 Insérez le CD dans votre ordinateur portable.

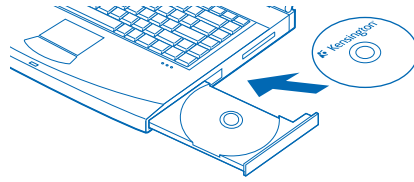

- 2 Suivez les instructions apparaissant à l'écran.  
**Remarque :** pendant l'installation, l'écran de votre ordinateur portable risque d'être vide pendant quelques secondes. Ceci est normal.
- 3 Redémarrez l'ordinateur lorsque vous y êtes invité.
- 4 Branchez l'alimentation sur la station d'accueil et sur une prise de courant.

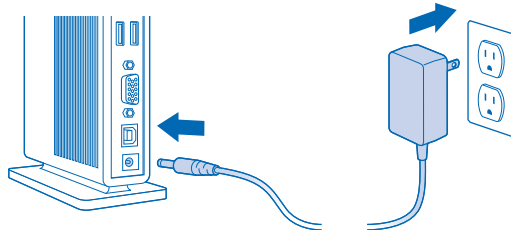

- 5 Connectez le câble USB 2.0 au connecteur USB sur la station d'accueil.

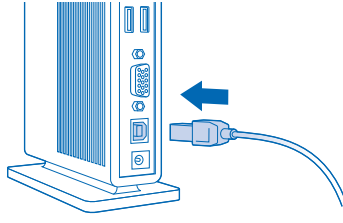

- 6 Branchez le câble USB 2.0 au port USB sur votre ordinateur portable.

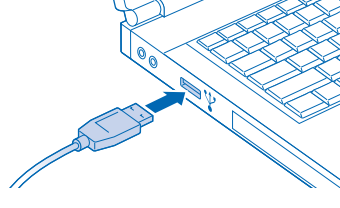

- 7 Connectez les périphériques—souris, moniteur, etc.—à la station d'accueil.

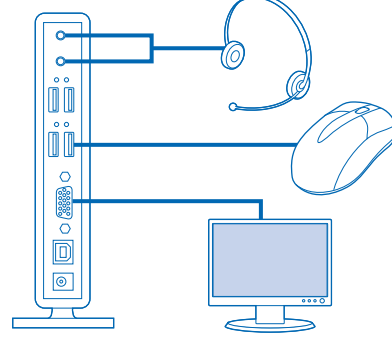

- 8 (Facultatif) Si vous connectez un moniteur, réglez les paramètres d'affichage :
  - a Cliquez avec le bouton droit de la souris sur l'icône Kensington dans la barre des tâches.
  - b Sélectionnez Etendue (DualView) ou Clone.
  - c Sélectionnez la résolution d'écran souhaitée.

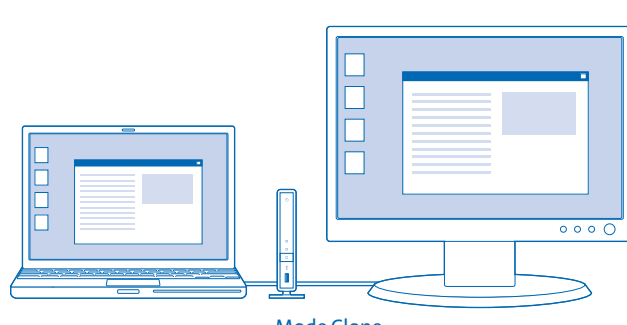
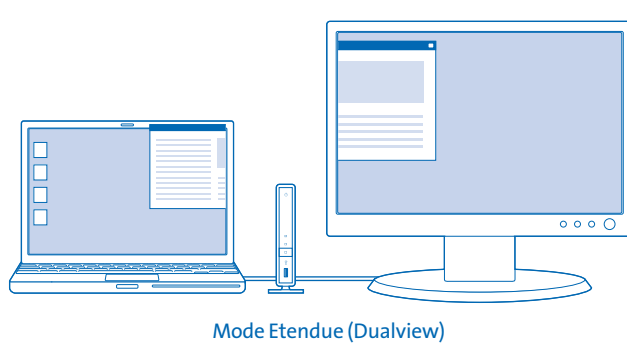

- 9 (Facultatif) Pour afficher le guide d'instructions détaillé, sélectionnez Démarrer/Tous les programmes/sd200v.

Deutsch

Inhalt

- A. sd200v Notebook-Dockingstation mit Video
- B. USB 2.0-Kabel
- C. Netzteil
- D. Software-Installations-CD und Bedienungsanleitung
- E. Kurzanleitung

Komponenten

Rückseite

- F. Stereo-Audioausgang
- G. Mikrofoneingang
- H. 4 USB-2.0-Schnittstellen mit Statusanzeigen
- I. VGA-Videoausgabe
- J. Vorgeschalteter USB-Anschluss
- K. Netzteilbuchse

Vorderseite

- L. Strom-/Verbindungs-Indikatoranzeige
- M. Indikatoranzeige 2 für Anzeigemodus
- N. Indikatoranzeige 1 für Anzeigemodus
- O. Taste "DualView"
- P. Statusanzeige für Front-USB-Anschluss
- Q. USB 2.0-Schnittstelle

Einrichten und Verbinden der Dockingstation

- 1 Legen Sie die CD in das Notebook ein.

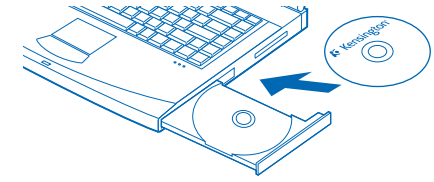

- 2 Befolgen Sie die Anweisungen auf dem Bildschirm.  
**Hinweis:** Während der Installation ist auf dem Notebook-Bildschirm möglicherweise für einige Sekunden keine Anzeige mehr zu sehen. Dies ist bei der Installation normal.
- 3 Starten Sie das Notebook neu, wenn Sie dazu aufgefordert werden.
- 4 Verbinden Sie das Netzteil mit der Dockingstation und einer funktionstüchtigen Steckdose.

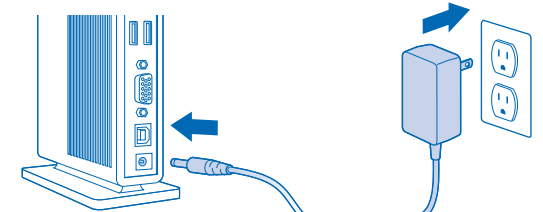

- 5 Stecken Sie das USB 2.0-Kabel mit dem vorgeschalteten USB-Anschluss an der Dockingstation.

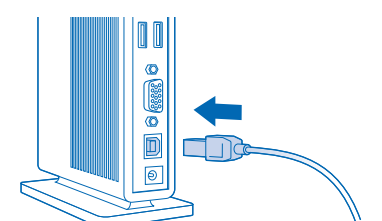

- 6 Stecken Sie das USB 2.0-Kabel in die USB-Schnittstelle des Notebooks.

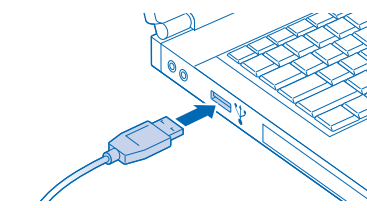

- 7 Verbinden Sie Geräte—Maus, Bildschirm usw.—mit der Dockingstation.

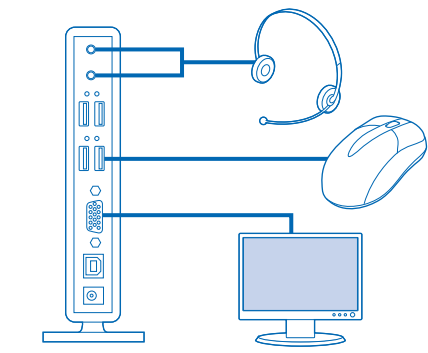

- 8 Optional) Passen Sie die Anzeigeeinstellungen an, wenn ein Monitor angeschlossen ist:
  - a Klicken Sie mit der rechten Maustaste auf das Kensington Symbol in der Taskbar.
  - b Wählen Sie Erweitert (DualView) oder Klon.
  - c Wählen Sie die gewünschte Bildschirmauflösung.

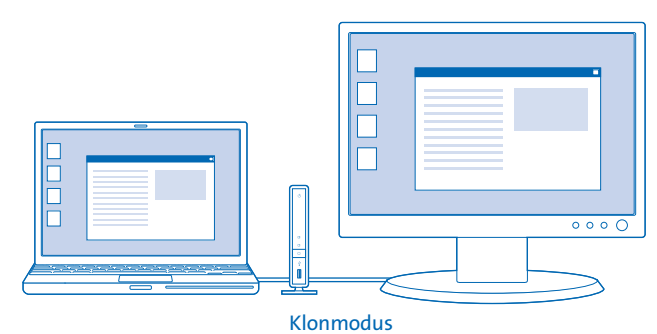
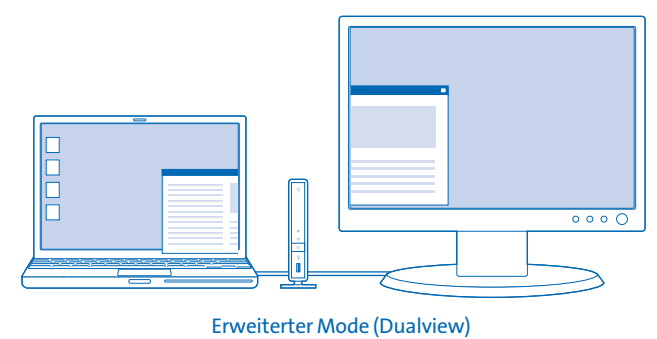

- 9 (Optional) Um detaillierte Informationen in der Bedienungsanleitung anzuzeigen, wählen Sie Start/Alle Programme/sd200v.

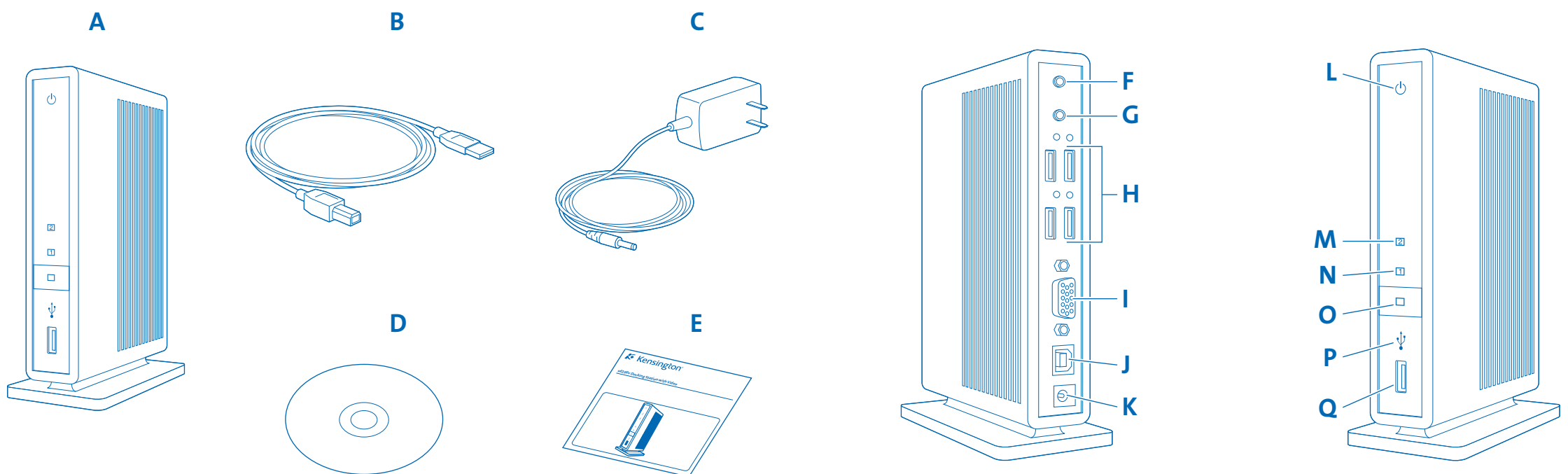

## Nederlands

### Inhoud

- A. sd200v-dockingstation met video voor notebooks
- B. USB 2.0-kabel
- C. Voedingsadapter
- D. Software-installatie-CD en handleiding
- E. Snelstartgids

### Onderdelen

#### Achterzijde

- F. Stereo audio-uitgang
- G. Microfooningang
- H. 4 USB 2.0-poorten met statusindicatielampjes
- I. VGA-video-uitgang
- J. USB-upstreamconnector
- K. Aansluiting voedingsadapter

#### Voorzijde

- L. Voedings-/verbindingsindicatielampje
- M. Indicatielampje weergavemodus 2
- N. Indicatielampje weergavemodus 1
- O. Button DualView
- P. USB-verbindingslampje (voor)
- Q. USB 2.0-poort

### Dockingstation installeren en verbinden

- 1 Plaats de CD in het notebook.

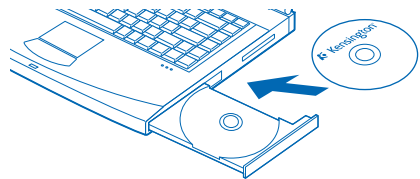

- 2 Volg de aanwijzingen op het scherm.

**Opmerking:** tijdens de installatie krijgt u mogelijk enkele seconden een blanco scherm. Dit is een normaal onderdeel van het installatieproces.

- 3 Start het notebook opnieuw op, indien hierom wordt gevraagd.
- 4 Sluit de voedingsadapter aan op het dockingstation en een stopcontact.

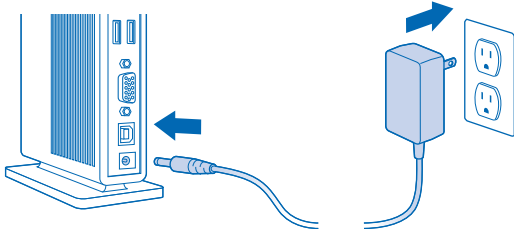

- 5 Sluit de USB 2.0-kabel aan op de USB-upstreamconnector op het dockingstation.

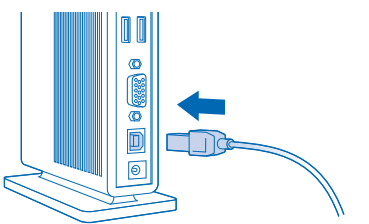

- 6 Sluit de USB 2.0-kabel aan op de USB-poort op het notebook.

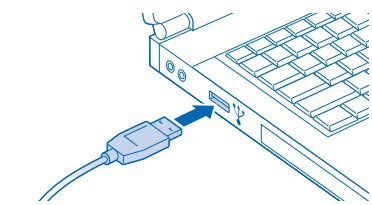

- 7 Sluit apparatuur—muizen, monitor, enz.—aan op het dockingstation.

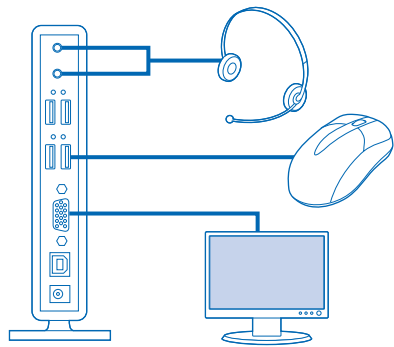

- 8 (Optioneel) Als de monitor wordt aangesloten, past u de weergave-instellingen aan:

- a Klik met de rechtermuisbutton op het Kensington-pictogram  in het systeemvak.
- b Selecteer Extended (DualView) (Uitgebreid (DualView)) of Clone (Kloon).
- c Selecteer de gewenste schermresolutie.

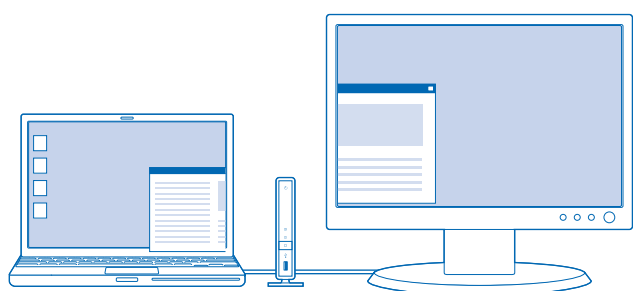

Extended mode (DualView) (Uitgebreid (DualView))

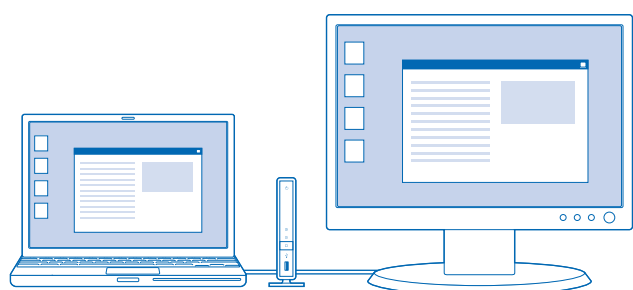

Modus Clone (Kloon)

- 9 (Optioneel) Ga voor de gedetailleerde handleiding naar Start/Alle programma's/sd200v.

## Italiano

### Contenuto

- A. Dock di espansione sd200v per notebook con video
- B. Cavo USB 2.0
- C. Alimentatore di corrente
- D. CD di installazione del software e Manuale di istruzioni
- E. Guida veloce

### Componenti

#### Lato posteriore

- F. Uscita audio stereo
- G. Ingresso del microfono
- H. 4 porte USB 2.0 con spia di stato di funzionamento
- I. Uscita video VGA
- J. Connettore upstream USB
- K. Jack dell'alimentatore di corrente

#### Lato anteriore

- L. Spia di alimentazione/connesione
- M. Spia 2 della modalità di visualizzazione
- N. Spia 1 della modalità di visualizzazione
- O. Pulsante DualView
- P. Spia anteriore di stato della connessione USB
- Q. Porta USB 2.0

### Installazione e collegamento del dock di espansione

- 1 Inserire il CD nel notebook.

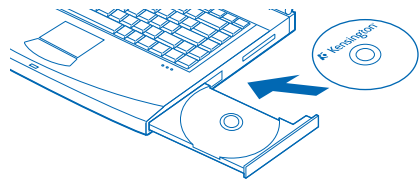

- 2 Seguire le istruzioni visualizzate sullo schermo.

**Nota:** durante l'installazione lo schermo del notebook può restare nero per alcuni secondi. Si tratta di una parte normale del processo d'installazione.

- 3 Riavviare il notebook se richiesto.
- 4 Collegare l'alimentatore di corrente al dock di espansione e alla presa a muro.

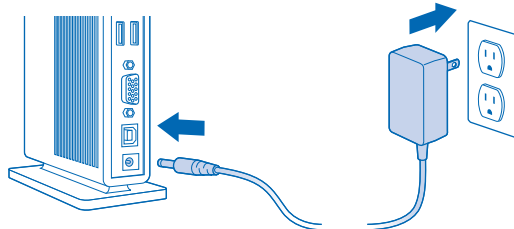

- 5 Collegare il cavo USB 2.0 al connettore upstream USB presente sul dock di espansione.

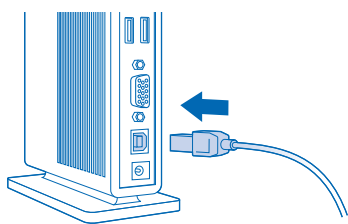

- 6 Collegare il cavo USB 2.0 alla porta USB del notebook.

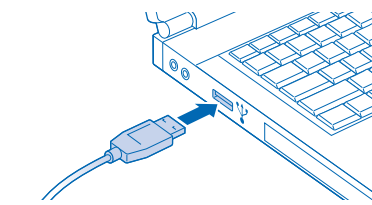

- 7 Collegare le periferiche (mouse, tastiera, monitor e così via) al dock di espansione.

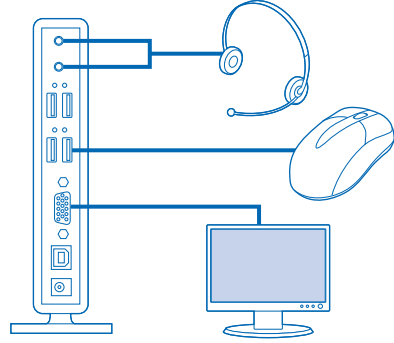

- 8 (Opzionale) Se il monitor è connesso, modificare le impostazioni del display.

- a Fare clic con il pulsante destro del mouse sull'icona Kensington  nella barra di sistema.
- b Selezionare Estesa (DualView) o Clonazione.
- c Selezionare la risoluzione desiderata per lo schermo.

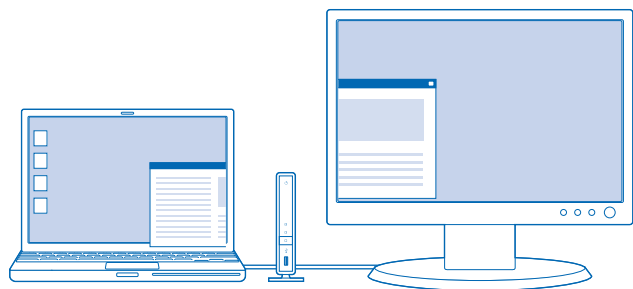

Modalità estesa (DualView)

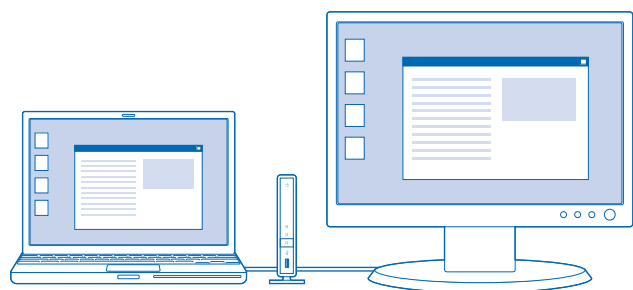

Modalità di clonazione

- 9 (Opzionale) Per visualizzare il Manuale di istruzioni dettagliato, andare su Start/Tutti i programmi/sd200v.

## Español

### Contenido

- A. Replicador de puertos sd200v con video para portátil
- B. Cable USB 2.0
- C. Adaptador de alimentación
- D. CD de instalación de software y Manual de instrucciones
- E. Guía de inicio rápido

### Componentes

#### Parte trasera

- F. Salida de audio estéreo
- G. Entrada de micrófono
- H. 4 puertos USB 2.0 con indicadores luminosos de estado
- I. Salida de video VGA
- J. Conector de la fuente de datos USB
- K. Clavija del adaptador de alimentación

#### Parte frontal

- L. Indicador luminoso de alimentación/conexión
- M. Indicador luminoso de modo de visualización 2
- N. Indicador luminoso de modo de visualización 1
- O. Botón DualView
- P. Indicador de estado de conexión USB frontal
- Q. Puerto USB 2.0

### Instalación y conexión del replicador de puertos

- 1 Inserte el CD en el equipo.

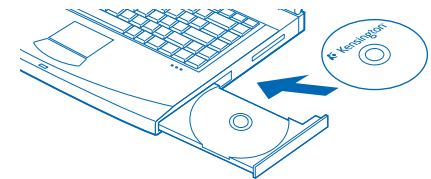

- 2 Siga las instrucciones que aparecen en pantalla.

**Nota:** durante la instalación es posible que se vaya la imagen de la pantalla del portátil. Esto forma parte del proceso normal de instalación.

- 3 Reinicie el portátil si se le pide.
- 4 Una el adaptador de alimentación al replicador de puertos y a la toma de pared.

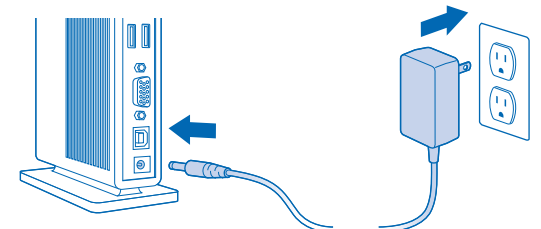

- 5 Conecte el cable USB 2.0 al conector de la fuente de datos USB del replicador de puertos.

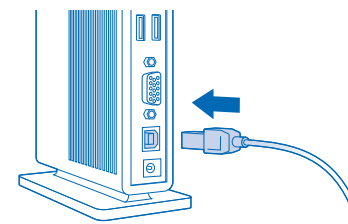

- 6 Una el cable USB 2.0 al puerto USB del portátil.

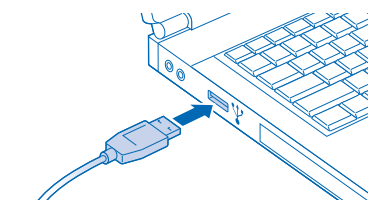

- 7 Conecte dispositivos: ratones, monitor, etc. al replicador.

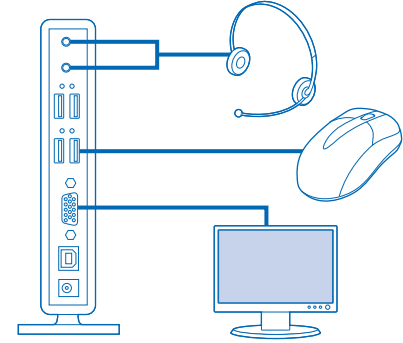

- 8 (Opcional) Si el monitor está conectado, ajuste los parámetros de visualización:

- a Haga clic con el botón derecho en el icono de Kensington  de la barra de tareas.
- b Seleccione Extendido (DualView) o Clon.
- c Seleccione la resolución de pantalla deseada.

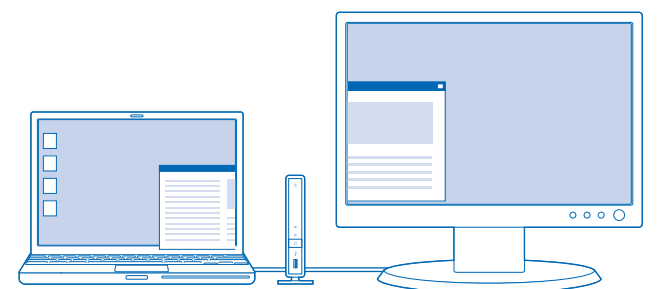

Modo extendido (DualView)

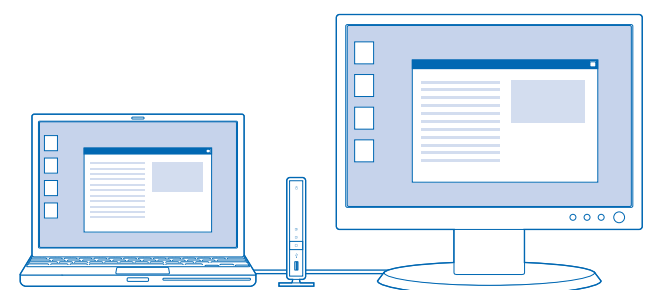

Modo clon

- 9 (Opcional) Para ver el Manual de instrucciones detallado, vaya a Inicio/Todos los programas/sd200v.